

Type	Width [mm]	Height [mm]	Depth from wall [mm]	Connections spacing [mm]	Connections distance from the wall [mm]	Brackets spacing [mm]	Heating surface [m ²]	Weight [kg]	Capacity [dm ³]	Power (75/65/20°C) [W]	Power (75/65/24°C) [W]	Power (55/45/24°C) [W]	Electric heater maximum power [W]
	W	H	D	C	B	A							
MDP0600061514L071000	600	615	133	50	93	490	1,77	30,1	10,3	619	558	276	-
MDP0600047114L071000	600	471	133	50	93	490	1,39	25,8	8,8	486	439	216	-
MDP1000061514L071000	1000	615	133	50	93	890	2,83	42,7	15,2	1032	931	459	-
MDP1000047114L071000	1000	471	133	50	93	890	2,19	35,5	12,6	811	731	360	-
MDP1400061514L071000	1400	615	133	50	93	1290	3,89	55,3	20,1	1445	1303	643	-
MDP1400047114L071000	1400	471	133	50	93	1290	3,00	45,2	16,4	1135	1024	505	-
MDP1800061514L071000	1800	615	133	50	93	1690	4,95	67,9	25,0	1858	1675	827	-
MDP1800047114L071000	1800	471	133	50	93	1690	3,81	55,0	20,2	1459	1316	649	-
MDP2200061514L071000	2200	615	133	50	93	2090	6,01	80,5	29,8	2270	2030	945	-
MDP2200047114L071000	2200	471	133	50	93	2090	4,62	64,7	24,0	1784	1608	793	-

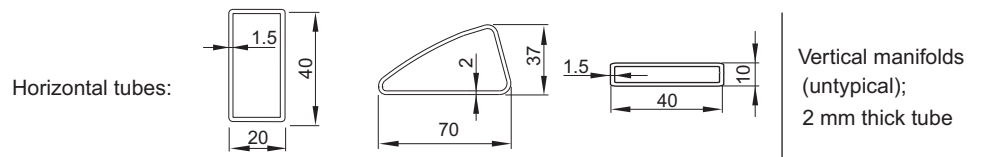

Finishing and warranty:	Electrophoresis + polyester-epoxy lacquer; 10 year warranty;
Mounting brackets:	Galvanized snap fastener mounting brackets are included
Valve:	order separately
Heater:	-
Working pressure:	4 bars
Maximum temperature:	95°C

Connections:	 inner threads G 1/2 air-vent plug G1/8 hidden behind
--------------	---

Remarks:

- Location of connections and the feed pipe: on the left side of the radiator
- Connections to the right side available upon request (in this case the feed pipe is on the right side, whereas the return pipe is on the left)

